



GI 700 MC



GI 700 ME

	GI 700 MC	GI 700 ME
	mechanical two-stage progressive	electronic two-stage progressive
Gas burner compliant with European standard EN676. Operation:		
Continuous modulation operation by installing P.I.D. controller in the control panel (to be ordered separately with modulation probe).	•	•
Modulation ratio:	1:7	1:7
Low NOx and CO emissions gas burner according to European standard EN676:	class 2	class 2
Adjusting the combustion head.	•	•
Maintenance facilitated by the possibility of removing the mixing unit without having to remove the burner from the boiler.	•	•
Fixed boiler coupling flange.	•	•
Easy maintenance thanks to the two-sides hinge which allows the removal of the combustion head without having to remove the burner from the boiler.	•	•
Combustion air intake with butterfly valve. Air flow adjustment:	mechanical cam	electric servomotor
Fully closing air damper on shutdown to avoid loss of heat through the chimney.	•	•
CE version gas train is complete with butterfly valve, operation and safety valve with electromagnetic drive, valve tightness control, minimum and maximum pressure switch, pressure regulator and gas filter.	•	•
Fail proof connectors for burner/gas train connection.	•	•
Gas train outlet:	up	up/down
Flame detection by ionisation electrode with connector for microamperometer.	•	•
Control panel equipped either with display showing the working process and with the keyboard for the burner adjustment.		•
Electric protection rating:	IP40	IP40

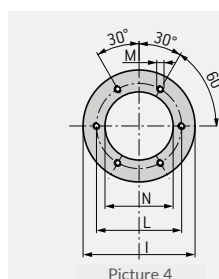
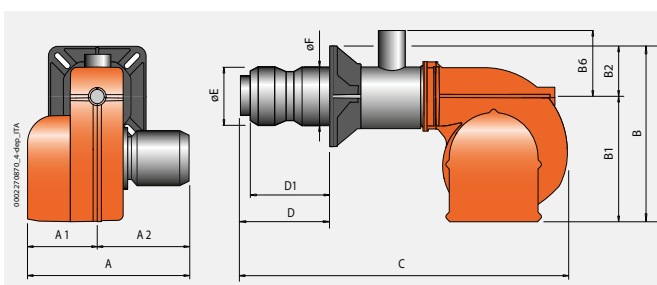
Flange dimensions
and boiler drilling
template.

Model	A mm	A1 mm	A2 mm	B1 mm	B2 mm	B5 mm	C mm	D mm	E mm	F mm	I mm	L mm	M mm	N mm	Pic.
GI 700 MC	1080	415	665	580	320	290	1830	500	390	325	580	520	M20	400	4
GI 700 ME	1065	400	665	580	320	290	1830	500	390	325	580	520	M20	400	4

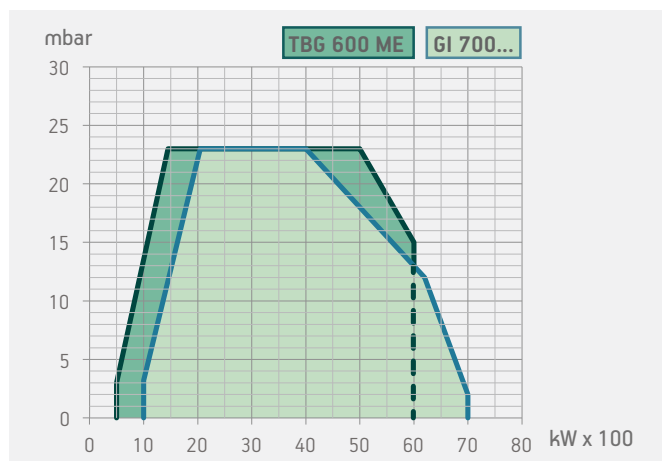

Model	Size of packaging			Weight kg
	L	P mm	H	
GI 700 MC	1530	1150	960	320
GI 700 ME	1530	1150	960	320

	Emissions class	Thermal output kW	Model	Part no.	Electrical supply kW	Motor	Note
Frequency 50 Hz							
	class 2	1000 ÷ 7000	GI 700 MC	66440030	3N AC 50Hz 400V	18,5	4)
	class 2	1000 ÷ 7000	GI 700 ME	66430030	3N AC 50Hz 400V	18,5	4)
Frequency 60 Hz							
	class 2	1000 ÷ 7000	GI 700 MC	66445410	3N AC 60Hz 380V	22,0	4)
	class 2	1000 ÷ 7000	GI 700 ME	66435420	3N AC 60Hz 380V	22,0	4)

MODULATING MODE

DESCRIPTION	PART NO.
Modulation kit	98000055
Modulating probe kit (see page 288)	

ACCESSORIES AVAILABLE ON REQUEST

DESCRIPTION	PART NO.
Soundproof burner cover (see page 293)	97980058

GAS BURNERS ACCESSORIES

Boiler coupling kit.

NOTES

4) Equipped with air closure device.

Net calorific value at reference conditions of 0°C, 1013mbar:

Natural gas: $H_i = 35,80 \text{ MJ/m}^3 = 8550 \text{ kcal/m}^3$,

For different type of gas and pressure values, please get in contact with our commercial department.

BURNER/GAS TRAIN MATCH

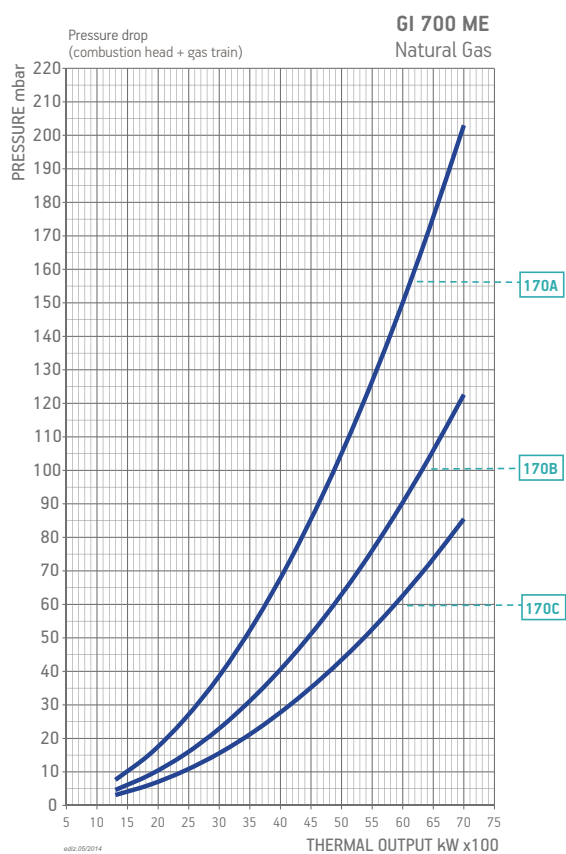
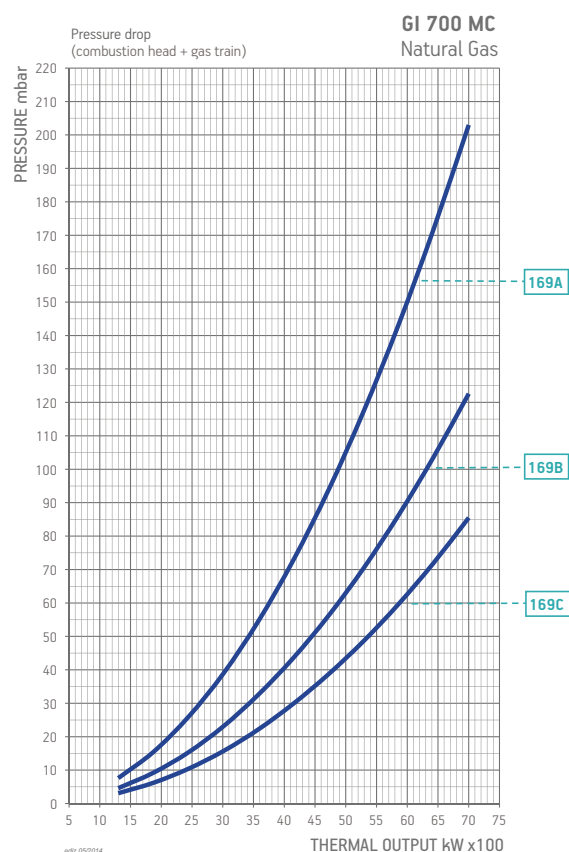
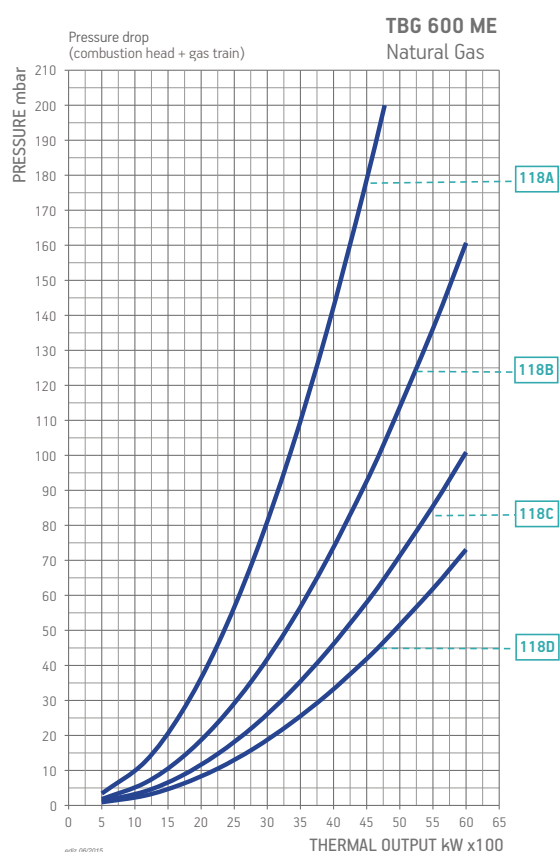

BURNER/GAS TRAIN MATCH

CE gas train version complies with EN676, EXP gas train version is for extra-European markets

Burner model	Gas type	Curve on graph	Version	P.Max ** mbar	Execution	Gas train	Regulator with incorporated filter	Burner/gas train adapter	Valve tightness control kit	Pic.	Notes
						Part no.	Part no.	Part no.	Part no.		
TBG 600 ME TBG 600 ME V TBG 600 ME V O2 TBG 600 ME V CO	Natural gas	118A	CE/EXP	500	CTV	19990541	Included	-	Included	D4	
		118B	CE/EXP	500	CTV	19990542	Included	-	Included	D4	
		118C	CE/EXP	500	CTV	19990543	Included	-	Included	D4	
		118D	CE/EXP	500	CTV	19990544	Included	-	Included	D4	
GI 700 MC	Natural gas	169A	CE	500	CTV	19990596	Included	-	98000101	D8	11)
			EXP	500	CTV	19990596	Included	-	-	DE8	
		169B	CE	500	CTV	19990597	Included	-	98000101	D8	11)
			EXP	500	CTV	19990597	Included	-	-	DE8	
		169C	CE	500	CTV	19990598	Included	-	98000101	D8	11)
			EXP	500	CTV	19990598	Included	-	-	DE8	
		170A	CE/EXP	500	CTV	19990542	Included	-	Included	D4	
			EXP	500	CTV	19990542	Included	-	Included	D4	
GI 700 ME	Natural gas	170B	CE/EXP	500	CTV	19990543	Included	-	Included	D4	
		170C	CE/EXP	500	CTV	19990544	Included	-	Included	D4	

To choose the correct gas train please refer to the information on page 20.

For information on the structure, composition, and size of the gas train please refer to the diagrams on page 294.

NOTES

11 The train must be always completed with the VPS kit to comply with the EN676 regulations.

CTV Gas train with Valve Tightness Control.

***) Maximum gas inlet pressure at pressure regulator.

Gas burner compliant with European standard EN676. Operation:

Continuous modulation operation by installing P.I.D. controller in the control panel (to be ordered separately with modulation probe).

Modulation ratio:

Low NOx and CO emissions gas burner according to European standard EN676:

Maintenance facilitated by the possibility of removing the mixing unit without having to remove the burner from the boiler.

Fixed boiler coupling flange.

Easy maintenance thanks to the two-sides hinge which allows the removal of the combustion head without having to remove the burner from the boiler.

Combustion air intake with butterfly valve. Air flow adjustment:

Fully closing air damper on shutdown to avoid loss of heat through the chimney.

Device made of sound-absorbing material to reduce fan noise.

Adjustment of fan revolutions according to working stage by means of a frequency converter in order to reduce noise and electric consumption.

Residual oxygen (O₂) monitoring in the fumes in order to maintain an optimal air/fuel ratio and ensure increased performance.

Residual oxygen (O₂) and carbon monoxide (CO) and monitoring of oxidizing components (H₂) in fumes to ensure increased performance and less atmospheric pollution.

CE version gas train is complete with butterfly valve, operation and safety valve with electromagnetic drive, valve tightness control, minimum and maximum pressure switch, pressure regulator and gas filter.

Fail proof connectors for burner/gas train connection.

Gas train outlet:

Flame detection by ionisation electrode with connector for microamperometer.

Control panel with display diagram for working mode with indication lights.

Control panel equipped either with display showing the working process and with the keyboard for the burner adjustment.

Electric protection rating:

TBG 800 MC	TBG 800 ME	TBG 800 ME V	TBG 800 ME V O ₂	TBG 800 ME V CO
mechanical two-stage progressive	electronic two-stage progressive	modulating electronic	modulating electronic	modulating electronic
•	•			
1:10	1:10	1:10	1:10	1:10
class 3	class 3	class 3	class 3	class 3
•	•	•	•	•
•	•	•	•	•
•	•	•	•	•
mechanical cam	electric servomotor	electric servomotor	electric servomotor	electric servomotor
•	•	•	•	•
•	•	•	•	•
		•	•	•
			•	
				•
•	•	•	•	•
•	•	•	•	•
down	up/down	up/down	up/down	up/down
•	•	•	•	•
•				
	•	•	•	•
IP54	IP54	IP54	IP54	IP54

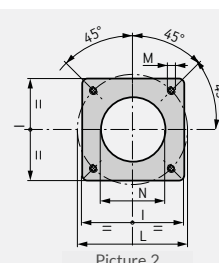
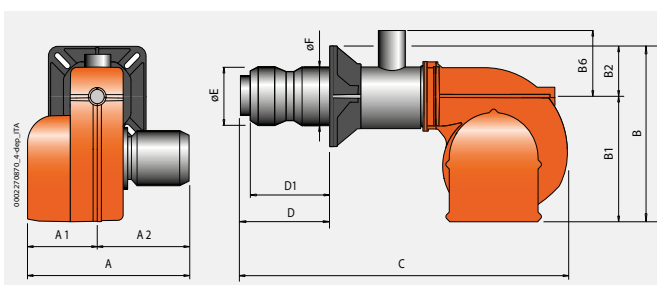

Flange dimensions and boiler drilling template.

Model	A mm	A1 mm	A2 mm	B mm	B1 mm	B2 mm	B6 mm	C mm	D mm	D1 mm	E mm	F mm	I mm	L mm	M mm	N mm	Pic.
TBG 800 MC	1230	570	660	1000	740	260	310	2020	720	570	418	432	520	594	M20	440	2
TBG 800 ME	1230	570	660	1000	740	260	310	2020	720	570	418	432	520	594	M20	440	2
TBG 800 ME V	1230	570	660	1000	740	260	310	2020	720	570	418	432	520	594	M20	440	2
TBG 800 ME V O ₂	1230	570	660	1000	740	260	310	2020	720	570	418	432	520	594	M20	440	2
TBG 800 ME V CO	1230	570	660	1000	740	260	310	2020	720	570	418	432	520	594	M20	440	2

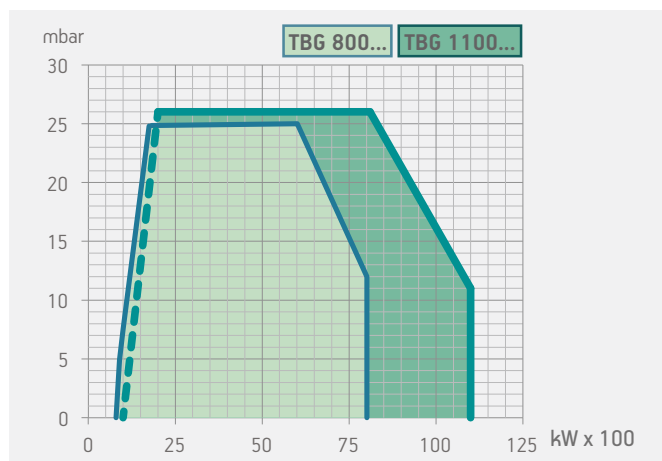

Model	Size of packaging			Weight kg
	L	P mm	H	
TBG 800 MC	1950	1510	1320	460
TBG 800 ME	1950	1510	1320	460
TBG 800 ME V	1950	1510	1320	480
TBG 800 ME V O ₂	1950	1510	1320	492
TBG 800 ME V CO	1950	1510	1320	504

		O ₂	CO	Emissions class	Thermal output kW	Model	Part no.	Electrical supply kW	Motor	Note
Frequency 50 Hz										
				class 3	800 ÷ 8000	TBG 800 MC	67230020	3N AC 50Hz 400V	15	4)
				class 3	800 ÷ 8000	TBG 800 ME	67220010	3N AC 50Hz 400V	15	4)
NEW	•			class 3	800 ÷ 8000	TBG 800 ME V	67220015	3N AC 50Hz 400V	15	4) 10)
NEW	•	•		class 3	800 ÷ 8000	TBG 800 ME V O ₂	67220016	3N AC 50Hz 400V	15	4) 10)
NEW	•	•	•	class 3	800 ÷ 8000	TBG 800 ME V CO	67220017	3N AC 50Hz 400V	15	4) 10)
Frequency 60 Hz										
				class 3	800 ÷ 8000	TBG 800 MC	67235420	3N AC 60Hz 380V	15	4)
				class 3	800 ÷ 8000	TBG 800 ME	67225410	3N AC 60Hz 380V	15	4)
NEW	•			class 3	800 ÷ 8000	TBG 800 ME V	on request	3N AC 60Hz 380V	15	4) 10)
NEW	•	•		class 3	800 ÷ 8000	TBG 800 ME V O ₂	on request	3N AC 60Hz 380V	15	4) 10)
NEW	•	•	•	class 3	800 ÷ 8000	TBG 800 ME V CO	on request	3N AC 60Hz 380V	15	4) 10)

TO COMPLETE THE BURNER

DESCRIPTION
TBG 800 ME V: modulating probe kit LCM 100 (see page 288)

MODULATING MODE

DESCRIPTION	PART NO.
TBG 800 MC: modulation kit	98000055
TBG 800 ME: modulation kit	98000059
TBG 800 MC/800 ME: modulating probe kit (see page 288)	

ACCESSORIES AVAILABLE ON REQUEST

DESCRIPTION	PART NO.
Soundproof burner cover (see page 293)	97980058
Nozzle kit for boiler at reverse flame.	98000361

GAS BURNERS ACCESSORIES

Boiler coupling kit.

NOTES

- 4 Equipped with air closure device.
 10 Inverter supplied separately, not included on the machine.
 Net calorific value at reference conditions of 0°C, 1013mbar:
 Natural gas: Hi = 35,80 MJ/m³ = 8550 kcal/m³,
 For different type of gas and pressure values, please get in contact with our commercial department.